

# The Lonsdale



Artist Impression

**AVANT**  
TOWNHOMES



# Designed for Torquay



The Lonsdale is the ultimate coastal townhome. Two levels of luxury provide separate zones for cooking, entertaining, working and relaxing – with cleverly integrated indoor and outdoor areas.

Downstairs the kitchen and indoor dining areas open up to an alfresco dining terrace and private courtyard.

The second level features three air conditioned bedrooms and a study – with the remarkable master suite having its own private balcony that leads to a spacious roof deck on the third floor.



# The Lonsdale Floorplan



Ground Floor



First Floor

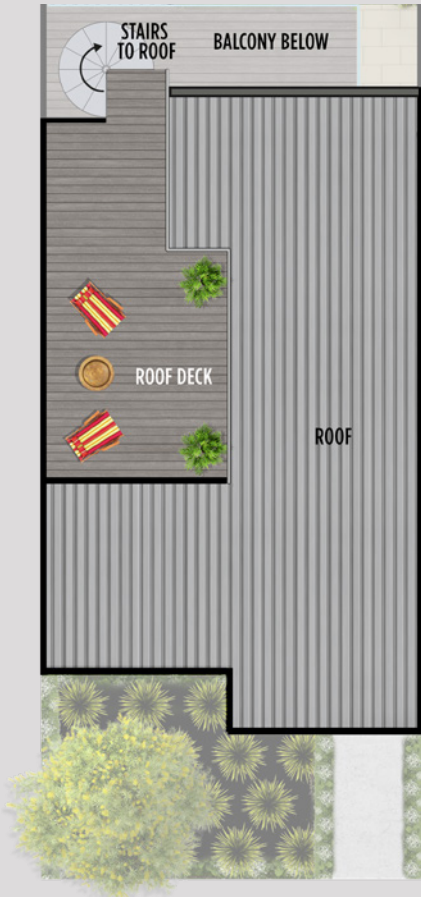

Rooftop Deck

| Area         | Sq metres               | Squares         |
|--------------|-------------------------|-----------------|
| Ground Floor | 69m <sup>2</sup>        | 7.42 sq         |
| First Floor  | 66m <sup>2</sup>        | 7.10 sq         |
| Garage       | 49m <sup>2</sup>        | 5.27 sq         |
| Porch        | 3m <sup>2</sup>         | 0.32 sq         |
| Alfresco     | 7m <sup>2</sup>         | 0.75 sq         |
| Balcony      | 7m <sup>2</sup>         | 0.75 sq         |
| Roof Deck    | 19m <sup>2</sup>        | 2.04 sq         |
| <b>Total</b> | <b>220m<sup>2</sup></b> | <b>23.65 sq</b> |





Artist Impression

Every detail is painstakingly planned, with filtered sunlight to every room and fresh sea breezes ventilating the entire house.

And, at the heart of the home, is the kitchen – spacious, beautifully designed and well-appointed with elegant finishes and quality appliances.



Artist Impressions are used throughout the brochure.



# Built to last



Artist Impression

The Lonsdale has been custom designed by Avant Townhomes for QUAY2 at Torquay.

The colours and materials of The Lonsdale have been carefully selected to suit the coastal location and climate.

Durable, low maintenance materials that will weather well with age.  
And marine grade stainless steel for the roof deck stairs and handrail  
– to endure a lifetime of sun, sea, salt and rain.





# Standard features

- Energy efficient, 6-star rating
- Double glazing throughout
- Photo-voltaic solar panels
- Reverse cycle heating and cooling to living areas and bedrooms
- Natural sandstone feature paving to front entry porch
- Reconstituted stone kitchen benchtops
- BBQ connected to mains gas
- Wall mounted 55" flatscreen Smart TV
- 12 month defect rectification period supported by RACV home assist with 24 hour cover, 7 days a week, every day of the year
- Single deposit and contract with no progress payments.

Images and Artist Impressions in this document are intended to be a visual aid only and do not necessarily depict the actual development. Avant Townhomes and Hume Torquay and Intrapac Property makes no warranty or representation as to the accuracy or sufficiency of any description, images or statements contained in this document and accepts no liability for any loss that may be suffered by any person who relies either wholly or in part upon the information presented. All information provided is indicative only and subject to change without notice including changes that may be required to gain authority approvals. Nominated items may be substituted without notice with a similar product at the discretion of Avant Townhomes and Hume Torquay and Intrapac Property. Title dimensions and boundaries are subject to registration of the final plan of subdivision. Any dimensions and areas shown in this document are indicative only. Any noted internal room dimensions are measured to the structural surface behind any plasterboard and other wall finish and building areas are generally measured to the external face of external walls and to the centerline of shared walls.

**INTRAPAC**  
PROPERTY

**Avant Townhomes Sales Centre at QUAY2**  
Corner Surf Coast Highway and Merrijig Drive, Torquay  
**1300 221 484** | [quay2.com.au/townhomes](http://quay2.com.au/townhomes)

**AVANT**  
TOWNHOMES