



# THE | TORQUAY

JM HOMES SURF COAST

...lifestyle by design

## LUXURY INCLUSIONS

- ⊗ Above six star energy rating
- ⊗ Concrete raft slab to M class specification
- ⊗ Double glazing throughout
- ⊗ Colorbond roof
- ⊗ Insulated garage door with remote control
- ⊗ Square set plastering
- ⊗ Ceramic tiles and quality carpet
- ⊗ Westinghouse stainless steel appliances inc dishwasher
- ⊗ Quality Argent tapware
- ⊗ Villeroy & Boch sanitary ware
- ⊗ Decina Bath
- ⊗ Tiled shower bases
- ⊗ Semi-frameless glass shower screens
- ⊗ Oliveri kitchen and laundry sinks
- ⊗ Caesarstone kitchen bench tops
- ⊗ Dalkin ducted split system heating/cooling
- ⊗ LED trader downlights
- ⊗ Trader light switches and power points
- ⊗ Insulated internal walls

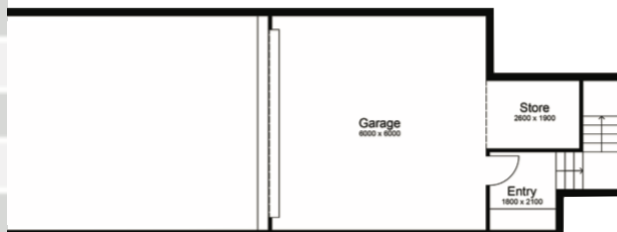

|   |   |   |   |   |   |
|---|---|---|---|---|---|
|  | 4 |  | 2 |  | 2 |
|---|---|---|---|---|---|

## TORQUAY HOME DIMENSIONS

|              |                 |                |
|--------------|-----------------|----------------|
| Residence    | 240.8sqm        | 25.92sq        |
| Garage       | 55.7sqm         | 5.99sq         |
| <b>TOTAL</b> | <b>296.5sqm</b> | <b>31.91sq</b> |
| HOME WIDTH   | 12.8m           |                |
| HOME LENGTH  | 25m             |                |

  
**\$10,000  
REBATE**  
ON TITLED LOTS  
QUAY2  
TORQUAY

**\$1,230,000**

Lot -721  
Lot area - 512m<sup>2</sup>  
Lot Frontage - 16m

Contact Hannah - 0437 335 727