



\$397,153*
FIXED PRICE

HARVEST RISE ESTATE Lot 375 Steed Road, Greenbank

 4

 2

 2

 2

+OUTDOOR

Home Size: 185.72m² | Lot Size: 350.00m² | 12.50m x 28.00m Lot

MONTROSE 20 SOUTHAMPTON FACADE
HOME AND LAND PACKAGE INCLUSIONS:

- ✓ Facade as shown

✓ Carpet and tiling

✓ Fixed price site works

✓ Exposed aggregate driveway and path to entry

✓ Integrated slab to outdoor living area (tiling not included)

✓ Letterbox

✓ Steel Frame and Colorbond Roof

✓ Panelift automatic garage door with 3 remotes
- ✓ Ceasarstone bench tops to kitchen, bathroom and ensuite

✓ Semi-frameless shower screen to bathroom and ensuite

✓ Extended tile height to 2100mm on vanity wall to bathroom and ensuite

✓ Stained timber feature front entry door

✓ Mirror sliding doors to robes

✓ NBN lead in

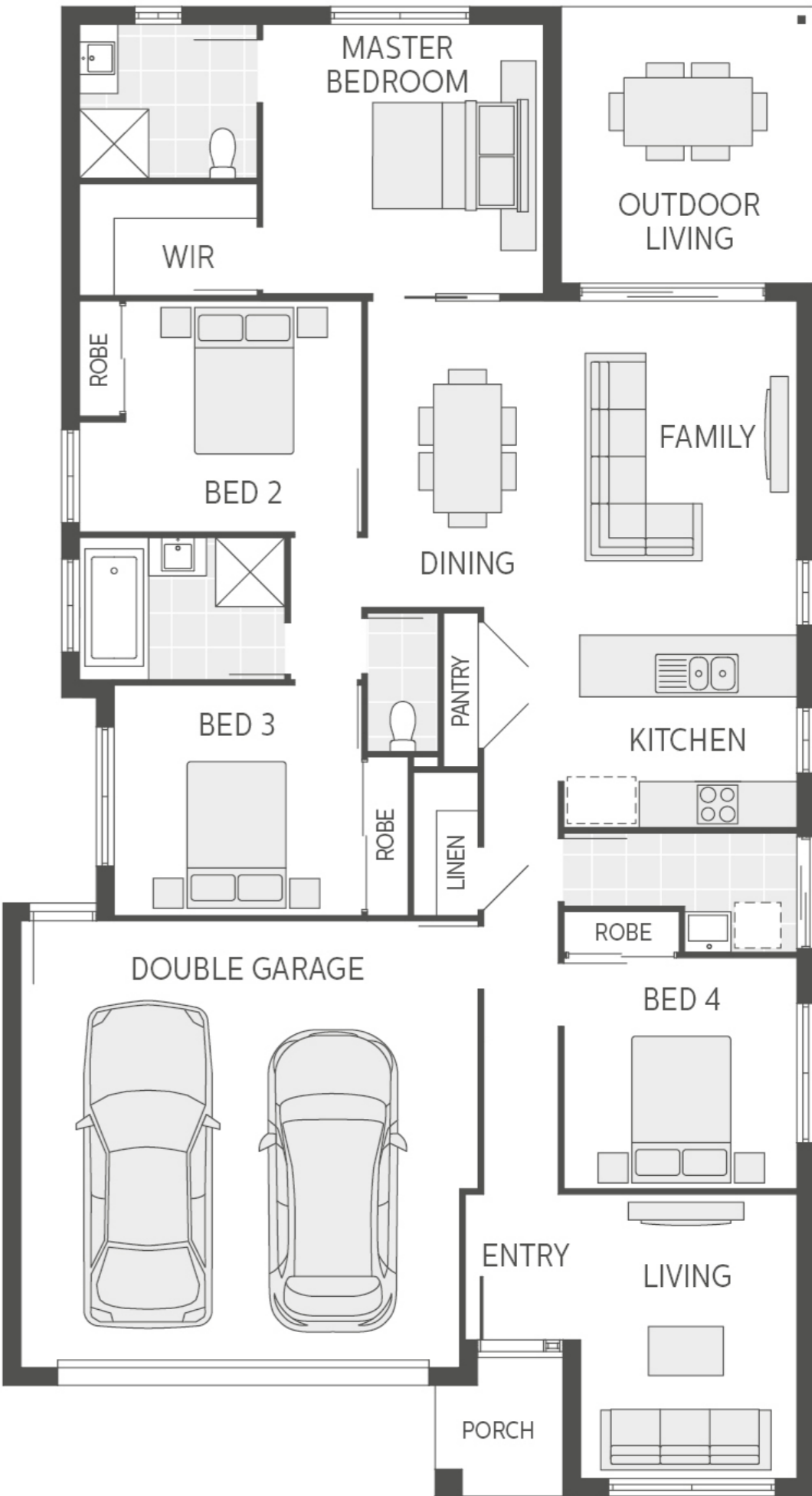

FOR MORE INFORMATION
Chadd Flavell | Coral Homes Sales Consultant
c.flavell@coralhomes.com.au
P: 0413 736 656 | M: 0413 736 656
7 Olive Ave cnr. Botanica Road, Greenbank, QLD

Floor plan is indicative only, conceptual in nature and subject to change. Floor plan may depict fixtures, fittings, features, finishes, inclusions, furnishings, vehicles and/or other products which are not included in the house design, not included in the package price and/or not available from Coral Homes¹.

¹Price shown is based on Coral Homes' 27-01-20 price list. Land price and availability is subject to change at any time and without notice. Land price at the time of printing is \$205,000. Price shown does not include additional amounts payable in respect of variations to the house design requested by the buyer. House siting is to be determined by Coral Homes. ¹Plan is subject to approval by the Principal Developer and Local Authorities. Coral Homes reserves the right to withdraw this package at any time without notice. QBCC 50792/1014053, OFT NSW 62084C, BLD260339.