

House and Land Package

FOR SALE



CONTACT: **George Racz**
TEL: 0419 528 139

\$526,860

Build With Choices

Build our Chisholm 19 in Clyde North's new Estate, Circa 1886. This could be your new 4 bedroom, 1 living room home at an affordable price.



House type: **Chisholm 19**

House size: **19sq**

Lot no: **806**

Lot size: **420m2**

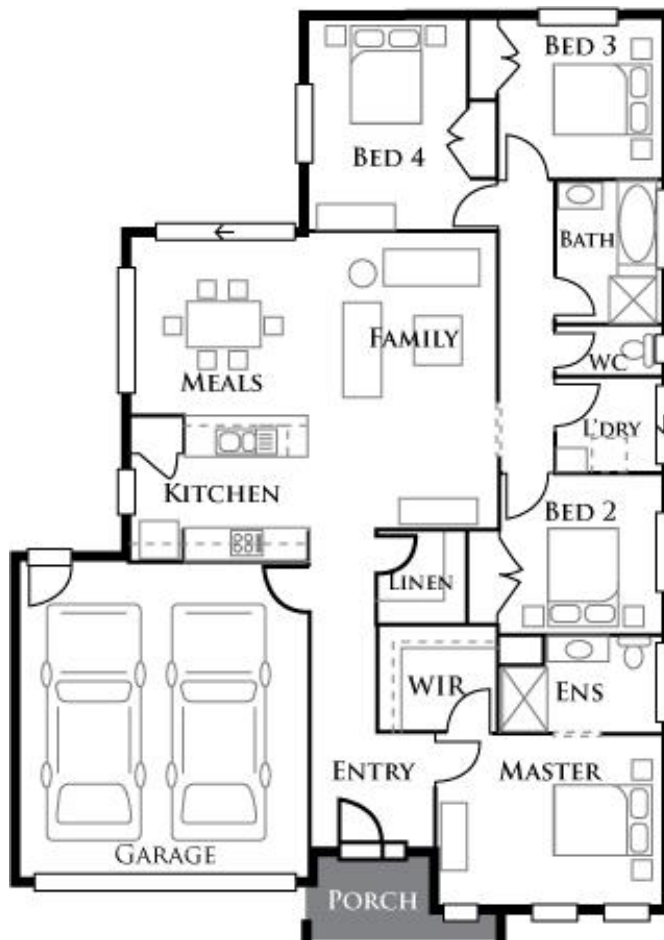

Includes:

- Site Work Allowance
- 20mm Edge Stone Benchtops to Kitchen
- Stainless Steel Kitchen appliances incl 600mm Baumatic Dishwasher
- Timber Laminate Flooring to Living Room
- Flyscreens to all openable windows
- National Broadband Connection
- Recycled Water Connection
- Ochre Facade
- Choose a Kitchen or Bathroom Upgrade - Promotion
- Gas Ducted Heating

This floorplan is subject to obtaining the following information, Final Working Drawings, Soil Report, Energy rating Report, Engineering Plans and Developer Approval (if required). NOTE: Sewer, Water, Gas, Stormwater and underground electrical pit to be made available by the client if not already available. This proposal includes the Builders Standard Specifications which are included herein, all pricing and items are subject to availability and may be modified within reason by the Builder with notice given to the building owner. Images are for illustration purposes only and may not represent the outcome for your new home exactly but are an indication based on what has been built by the builder previously.

CIRCA

 1886

Tel. 9018 7234
211 Grices Road, Clyde North
circaberwick.com.au