

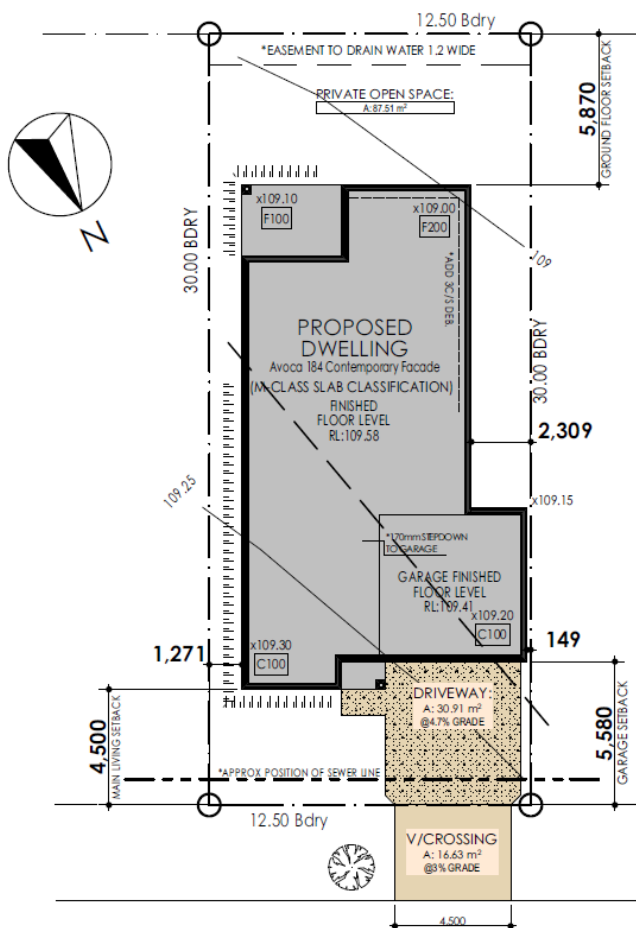

## CONTEMPORARY FAÇADE

LOT 965 RIBERRY STREET, GREGORY HILLS

**PRICE \$678,700**



### PACKAGE INCLUSIONS

- ✓ De Luxe Inclusions (see your Consultant or Fowler Homes website for full details)
- ✓ Reverse Cycle Ducted Air-Conditioning
- ✓ Stone Kitchen Benchtop
- ✓ SMEG Appliances
- ✓ Ceramic Tiles to Patio, Entry, Foyer, Kitchen, Dining & Family (selected from Fowler Homes standard range)
- ✓ Carpet to balance of the home (selected from Fowler Homes standard range)
- ✓ Plain concrete slab to Outdoor Retreat including tiles over (selected from Fowler Homes standard range)
- ✓ Freestanding bath
- ✓ Aluminium stacker doors (subject to design)
- ✓ Rheem continuous flow hot water system
- ✓ Sarking to underside of roof tiles
- ✓ Termite treated frames & trusses
- ✓ Painted finish to all timberwork
- ✓ NBN/Fibre Optic Connection
- ✓ Colour on concrete driveway & connecting path to Patio (up to 40sqm for a single garage & up to 60sqm for a double garage)
- ✓ Remote control to garage door with two handsets

LOT 965 RIBERRY STREET, GREGORY HILLS

**PRICE \$678,700**

**AVOCA 184**

TOTAL AREA - 184.41m<sup>2</sup>

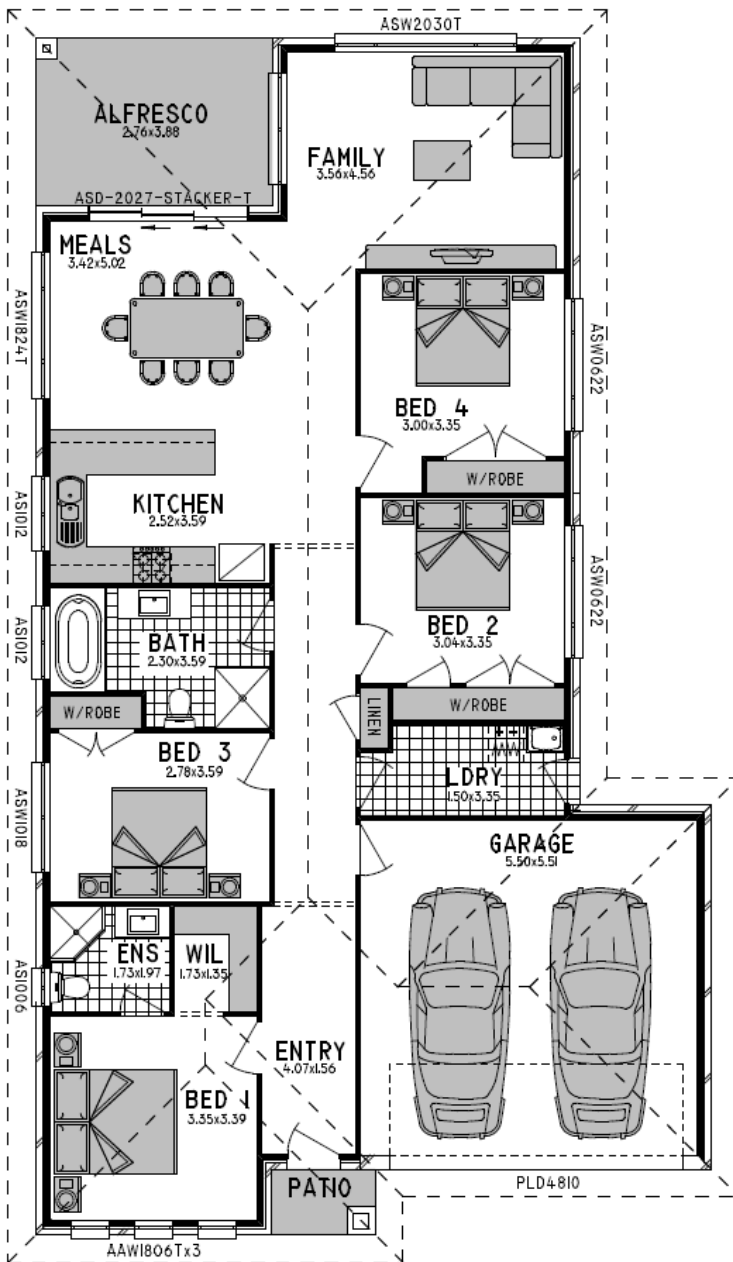

**LOT 965**

RIBERRY STREET  
GREGORY HILLS

**LAND SIZE:** 375 m<sup>2</sup>

**HOUSE WIDTH:** 11.080 m

**HOUSE DEPTH:** 19.630 m

For further details contact

**1800 606 675**

or visit your nearest

**FOWLER HOMES DISPLAY CENTRE**

**CENTRAL COAST**

Coming Soon

**MARSDEN PARK**

CNR Silverthorne Street, McLoughlin Street, Marsden Park

**THORNTON**

Rennington Street, Thornton

**ORAN PARK**

Sargent Street, Oran Park

**KELLYVILLE**

Cardell Rd, Kellyville

**GREGORY HILLS**

Village Circuit, Gregory Hills

\*All images and drawings including landscape plans are for illustrative purposes only & should only be used as a guide only. Purchasers are advised to refer to the Land Contract and or Builders Tender and Contract for precise dimensions, specifications and inclusions. Fowler Homes reserves the right to revise plans, specifications, materials and suppliers without notice. Fowler Homes Pty Ltd ABN 89 066 046 366 Builders License number 113647C. Effective as at 17<sup>th</sup> December 2016.