

PORTER DAVIS

REAL ESTATE

NEW HOME LIVING MADE EASY

5%
DEPOSIT#

90
DAYS*
READY TO
MOVE IN

Photo for illustration purposes only.

Complete price

\$619,900

First Home Buyers pay just

\$609,900

Move In

September 2019



Photo for illustration purposes only.

Lot 1566 Pablo Drive

CLYDE NORTH

392m²

**Monarch 20 + Bed4 +
Alfresco** (20.96 sq)

4  2  2 

**Why buy a Porter Davis
Real Estate home?**

- 5% deposit. Balance at settlement
- No progress payments
- Stamp Duty savings²
- Contracts ready to sign so you can move in sooner
- No obligation professional finance advice

PORTER DAVIS
REAL ESTATE

Monarch 20 + Bed4 + Alfresco (20.96 sq)

Lot 1566 Pablo Drive
CLYDE NORTH

Melways:

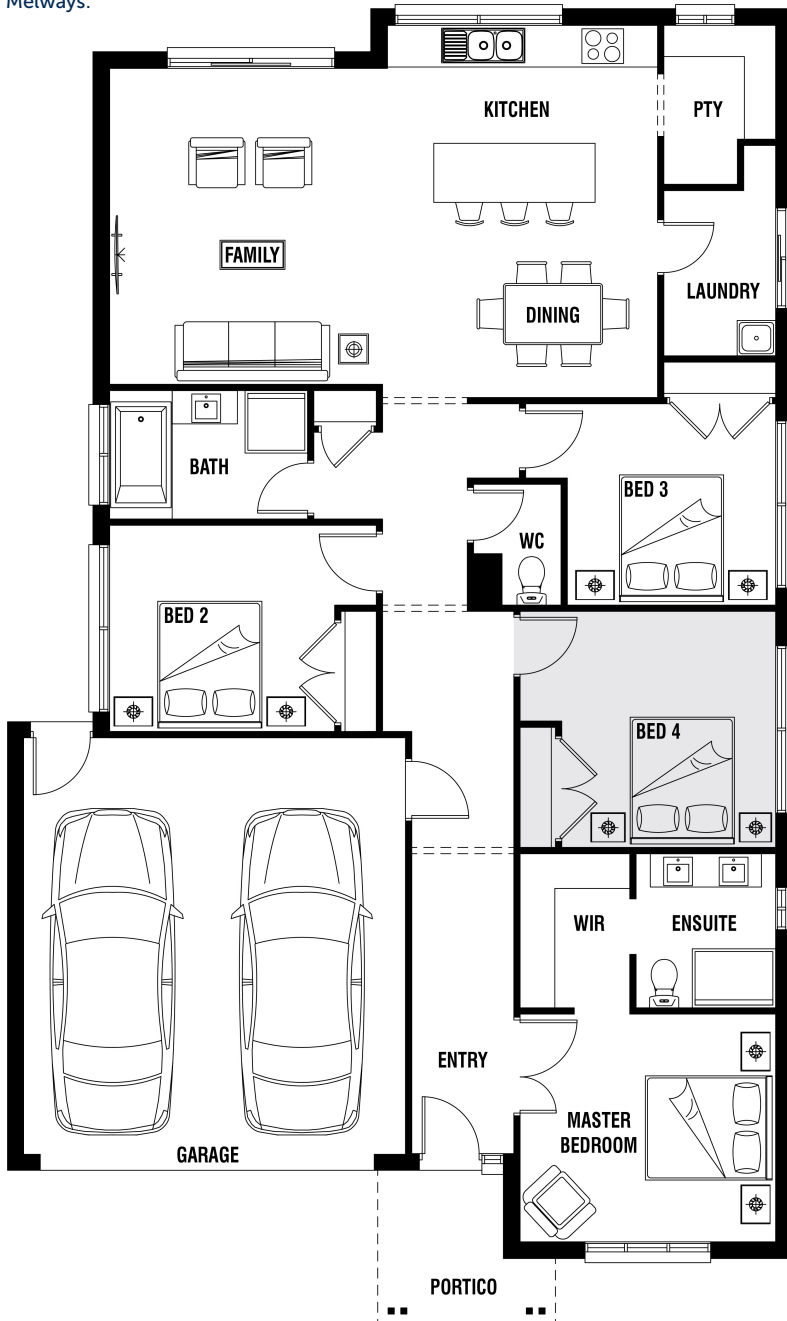

LUXURY TURN-KEY INCLUSIONS AT NO EXTRA COST

- KITCHEN
 - 20mm Silestone kitchen benchtop
 - Technika stainless steel 5 burner cooktop
 - Technika dishwasher and rangehood
 - Tiled splashback
- INTERIOR
 - Floor coverings to entire house
 - 20mm thick Silestone vanity top to ensuite and bathroom
 - 2590mm (8ft 6) high ceilings
 - 3 coat paint system
- EXTERIOR
 - Landscaping to front of block
 - Coloured concrete driveway and path to door
 - Letterbox
 - Remote controlled garage door with two transmitters
- EXTRAS
 - 7 year structural warranty
 - Full termite protection
 - Colour schemes chosen by industry leading interior designers.
- Plus much more!