

RATHDOWNE TOWNHOMES

URBAN PLACE
COLLECTION 4.0



SHAPE
homes



EUCALYPTUS B

3 2 2

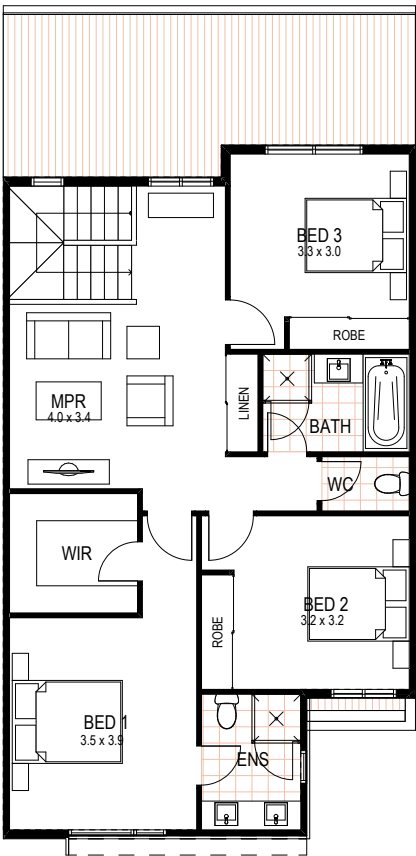
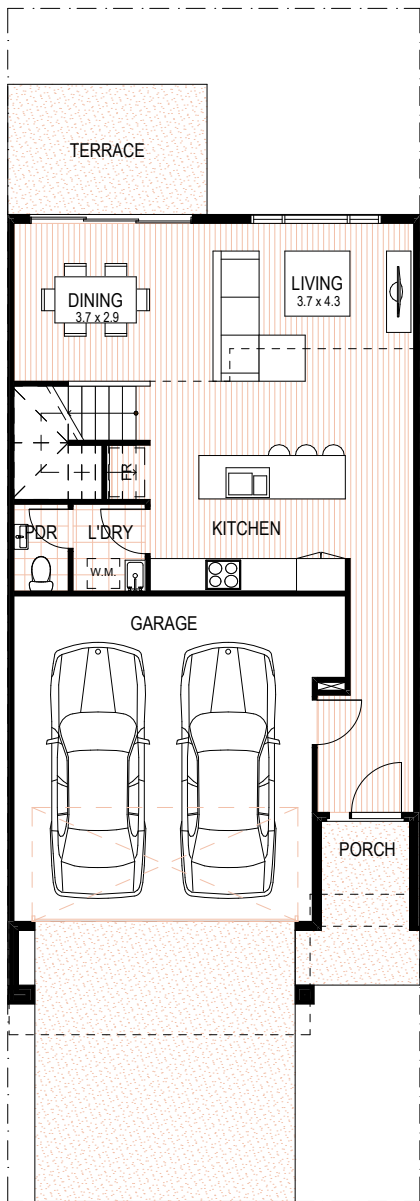

EUCALYPTUS B		
Ground Floor	61m ²	6.57sq
First Floor	85m ²	9.15sq
Garage	36m ²	3.88sq
Balcony	3m ²	0.32sq
TOTAL AREA	185m²	19.91sq

All images and drawings are illustrative only and may not be to scale. Floor plans are subject to change to comply with authority approval. Illustrations and information are intended to be indicative only and are believed to be correct at the time of publication. Shape Homes reserves the right to withdraw or alter at any time.

