



Trevi 21 | Seattle Facade

Facade images and landscaping may vary from this image

4 | 1 | 2 | 1

Lot 84 \$1,253,000

Estimated Land Registration 3rd Quarter 2022

Comfort, Kitchen and Electrical Security Packs Included. **Current Promotion included.** Land Size 315 SQM

This plan may include additional steps, please see a consultant

PACKAGE INCLUDES

- Quality Tiles & Carpet
- Blinds and Flyscreens to windows
- Insulation to walls and ceiling (excluding garage)
- 900mm Stainless Steel Oven, Cook top and Range hood. Stainless Steel Dishwasher
- 20mm stone bench top to kitchen with Soft close drawers and doors.
- Render to colour trims included
- Down lights to living Areas
- Automatic Garage Doors
- TV Antenna
- \$20,000 Off House and Land Already Applied
- Driveway, Landscaping, Site Costs & Fencing

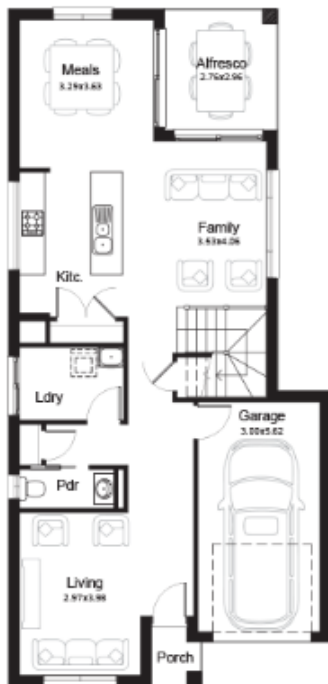



House Length	16.50m	Total Area m ²	194.26
House Width	7.85m	Total Area Squares	21