

HOME&LAND



Portofino 225 \$466,070

House: \$249,170 | Land: \$216,900

SEQUANA | LOGAN RESERVE | LOT 301 400M2



HOME INCLUSIONS

- M Class slab Included Plus Piering allowance
 - Council Fees Included
 - Contemporary Living Inclusions (See Brochure for details)
 - Fully Ducted Air Conditioning Included
 - Choice of Timber Look Laminate Flooring OR 450x450 Tiles to main living areas and Carpet to Media and Bedrooms
 - Caesarstone Benchtops through out including Laundry PLUS 40mm Stone to Kitchen Island Bench
 - LED downlights
 - 900mm Westinghouse Appliances to Kitchen
 - 2590mm Ceiling Height Through Out
 - Driveway allowance Included
 - Hamptons Façade Included
- **\$10,000 Discount Available – Contact Natalie to find out how.**



OPTION



OPTION

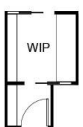

OPTION



OPTION



Australia's No.1 Medium Builder

CONTACT - Natalie Hill
0411 291 974
n.hill@boldliving.com.au