



# HOUSE & LAND

# \$554,339\*

## MERRIFIELD – MICKLEHAM

Lot 3949 Urquhart Street  
Mickleham VIC 3064

🚗 4 🏠 2 🚗 2 🚗 2 🏠 1

**Pearl 23 Livia Façade**  
(Aspirations)

Home size: 22.41sq Land size: 350m<sup>2</sup>

- ✓ Aspirations Inclusions
- ✓ BAL
- ✓ Fixed Site Costs
- ✓ Water Tank
- ✓ Recycled Water
- ✓ NBN Connection
- ✓ 2580mm Ceiling Height
- ✓ Remote control to garage door
- ✓ Flyscreens
- ✓ Ducted Heating
- ✓ Timber look laminate flooring to Entry/kitchen/meals/family
- ✓ Carpet to remaining areas
- ✓ Concrete paving to driveway and portico (up to 35m<sup>2</sup>)
- ✓ Designer front entry door
- ✓ Lockable internal access door from garage
- ✓ European designed stainless steel appliances
- ✓ Overhead cupboards with bulkhead above
- ✓ Designer mixer tapware throughout

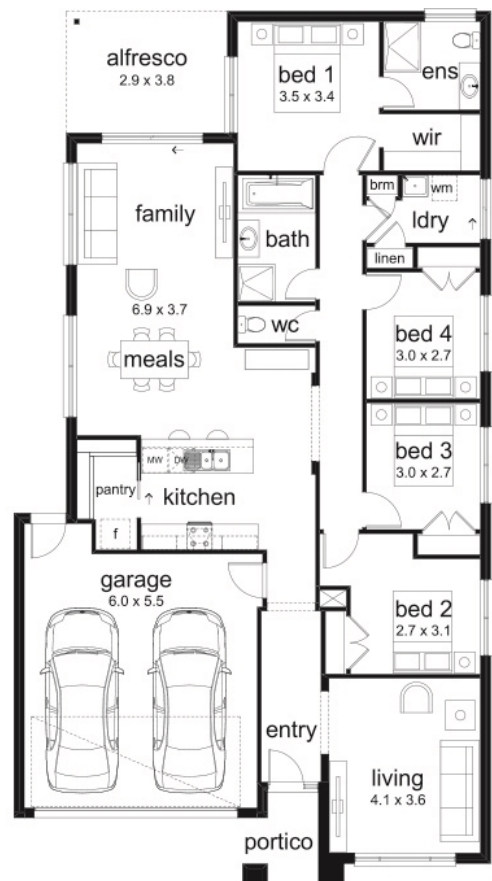

**merrifield**  
OUR KIND OF CITY

Go to [dennisfamily.com.au](http://dennisfamily.com.au) or call  
**1800 DENNIS** for more information.

Cheryl Jennings 0439 011246  
Reference HL0027302