



**VENTURE  
UPGRADES**

*Plus*  
FLOORING INCLUDED

# HOME AND LAND

Images shown are for illustrative purposes only and may not represent the final product such as lighting, window furnishings, timber look garage door & timber windows. Facade details including entry door and window sizing may vary between house types. Pricing also excludes features such as fencing, landscaping, letterbox, decking, driveway and any notable features of the facade. Please speak with your sales consultant for further details.

LOT 714, REDSTONE ESTATE, SUNBURY (350M2)

FLOOR PLAN: GRAMERCY 19\_176  
FACADE: INTERPID

**FIXED PRICE**

**\$512,316**

FIRST HOME OWNERS PRICE \$502,316

4 🚗 2 🍷 2 🚗 1 🚗 19sq 📏

**BIG CITY  
STYLE**



**METRO**

## PACKAGE INCLUSIONS:

- ▼ DEVELOPER & COUNCIL REQs
- ▼ FLOORING THROUGHOUT
- ▼ 20MM CAESARSTONE BENCHTOP TO KITCHEN
- ▼ OVERHEAD CUPBOARDS TO KITCHEN
- ▼ 20 LED DOWNLIGHTS
- ▼ BRICKWORK OVER WINDOWS
- ▼ 900MM APPLIANCES
- ▼ DISHWASHER
- ▼ 2590 CEILING HEIGHTS
- ▼ REMOTE TO GARAGE DOOR

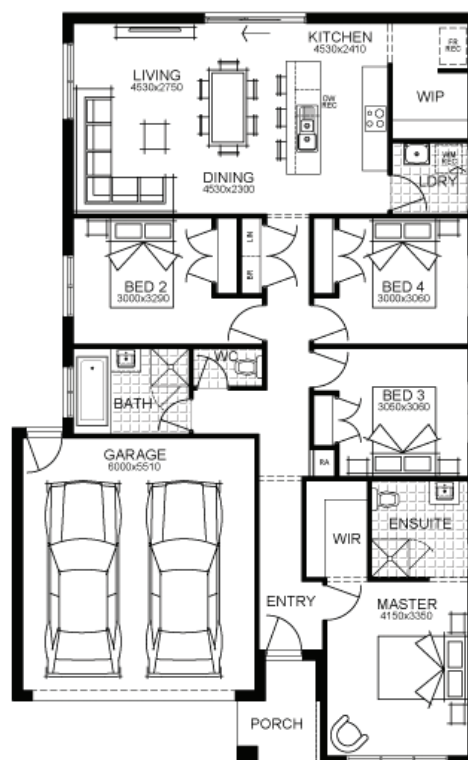

**For enquiries please contact:**  
Viola Vito

[Simonds.com.au](http://Simonds.com.au)

Metro North

VIC  
[viola.vito@simonds.com.au](mailto:viola.vito@simonds.com.au)

**Redstone.**  
*Your world awaits*