



CAMERON 17

House & Land Inclusions:

- Developer & Council Requirements
- 40mm stone benchtops to kitchen island
- 2740mm high ceilings
- 2340h internal & external doors
- Coloured concrete driveway & porch
- LED downlights throughout
- Vertical blinds to all windows and sliding doors
- 900mm appliances + dishwasher
- Stone benchtop to kitchen, ensuite, bath & laundry
- Tiles/12mm timber laminate to high traffic areas
- Plush carpet in bedrooms
- Flyscreens to all windows
- Flywire doors to the rear of home
- Alarm System
- Remote control to garage
- 3 Months Maintenance Period
- 10-year structural warranty

\$ 625,246

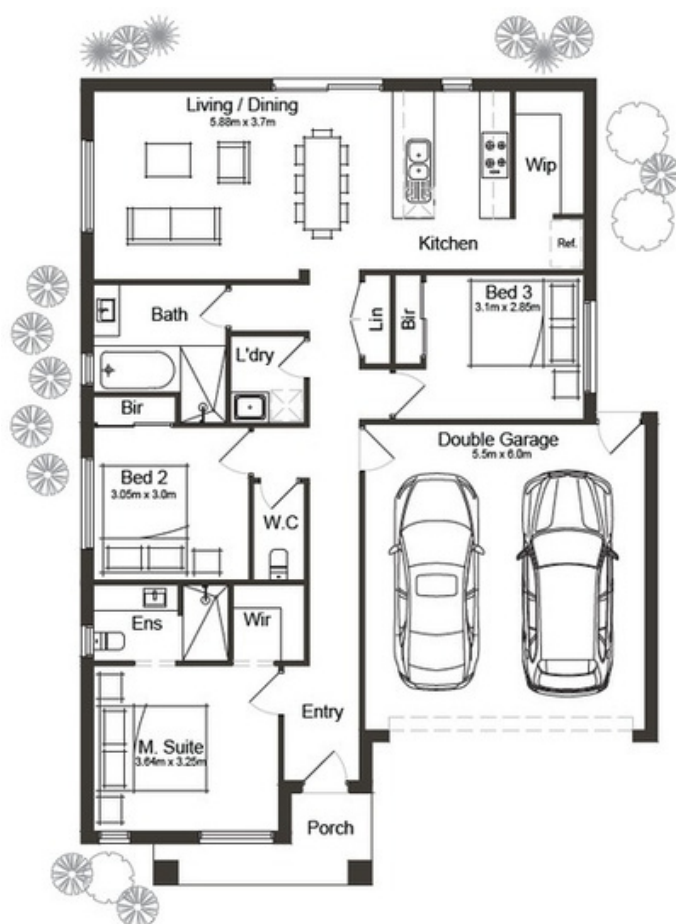

Lot Address: Lot 5433 Superb Road, Wyndham Vale VIC 3024
 Land Area: 12.5 X 21 | 262.5m²
 Build Area: 16.57SQ | 153.94m²



3 BED



2 BATH



OPEN PLAN



2 CAR PARK