



**dennis  
family  
homes**

a family building  
homes for families™



# HOUSE & LAND

# \$757,839\*

**WOODSONG – MICKLEHAM**

Lot 216 Driftwood Street  
Mickleham VIC 3064

🚗 4 🏠 2 🚗 2 🚗 2 🏠 1

**Jade 23 Tega Façade**  
(Aspirations Series 3)

Home size: 22.58sq Land size: 350.00m<sup>2</sup>

- ✓ 2KW PV Solar Panels System
- ✓ NCC 2022 Compliant
- ✓ 7 Star Energy Rating
- ✓ BAL 12.5 inclusions
- ✓ Site Costs Allowance
- ✓ Recycled water connection
- ✓ NBN/Opticomm/Redtrain/Multinet/CNT Corp. connection
- ✓ 2580mm ceiling height to ground floor
- ✓ Remote control to garage door
- ✓ Flyscreens
- ✓ 900mm Stainless Steel Appliances
- ✓ Gas ducted heating
- ✓ TV Antenna
- ✓ Floor Coverings
- ✓ 35 m2 of Concrete Drive and Paving
- ✓ Integrated dishwasher to match kitchen cabinetry
- ✓ Current Promotion
- ✓ 20mm Caesarstone benchtops to kitchen
- ✓ Feature Render
- ✓ Brick Infill to Garage
- ✓ Undermount sink
- ✓ Overhead cupboards to laundry (up to 900mm)
- ✓ 20 downlights

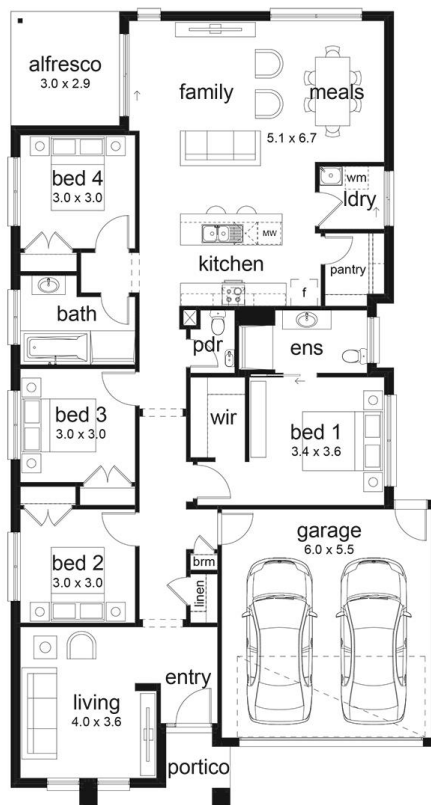

Go to [dennisfamily.com.au](http://dennisfamily.com.au) or call  
**1800 DENNIS** for more information.

Kurt Nilsson 0418667395

Reference HL0047779

**Woodsong**  
MICKLEHAM

\*Subject to land and build contracts for specified lot, available until sold. 1. Images not to scale and may differ from final built forms. 2. Landscaping, driveway, retaining walls, paving, decking, fencing, decorator items and furnishings not included. 3. Unless stated, site costs are not fixed, package price may increase depending on: rock removal and services connection costs, retaining walls, tree root mitigation, developer requirements, BAL zoning and other statutory requirements. 4. "Fixed site costs" packages include rock removal and services connection only, exclude retaining walls and tree root mitigation. 5. Price based on façade shown, excludes stamp duty, legal and transaction costs eg FIRB, finance fees. 6. Customers required to enter into a separate land contract with the land developer. 7. Prospective buyers should make and rely on their own enquiries and seek independent legal and financial advice. 8. Package not available in conjunction with any other promotions. 9. Additional options available, additional charges may apply. 10. Alternative facade options available additional charges may apply. ©2022. Dennis Family Homes Pty Ltd ACN 056254249 is a registered building practitioner CDB-U 49195 (Vic) and 173511C (NSW). ©2019. Dennis Family Homes Pty Ltd ACN 056254249 is a registered building practitioner CDB-U 49195 (Vic) and 173511C (NSW).